

## Hillands Drive, Cheltenham, Gloucestershire, GL53 9EU



Three bedroom family home with a large garden ● Two reception rooms ● Garage and driveway ●  
No through road ● Close to excellent local schools ● EPC D ●

# Hillands Drive,

Cheltenham, Gloucestershire, GL53 9EU

## Key Features



3  
Bedrooms



1  
Bathrooms



3  
Receptions

## About the property

This is a deceptively spacious three bedroom link detached family home situated within a quiet cut de sac close to good local amenities and schools with the benefit of a large mature garden.

The accommodation is arranged over two floors and in brief comprises an entrance hall, 21ft sitting room, with double doors leading into the 18ft dining room, this in turn leads to the garden room, there is a fitted kitchen, downstairs cloakroom and playroom which also has access into the garden.

On the first floor there three double bedrooms each with built in wardrobes/cupboards and a family bathroom.

Additional benefits of this lovely home include gas fired central heating, double glazing, an attached garage and off road parking. The gardens are a fabulous feature of the property measuring approx 90 x 45ft with an enclosed courtyard area 31 x 22ft which opens into a charming and private landscape garden, with a variety of mature shrubs, trees, lawned area and flowers.

## Amenities

Leckhampton is a quiet 'leafy' residential area situated just to the south of Cheltenham town centre, and often first on buyers' lists. Bath Road, which has an excellent collection of local shops, including a delicatessen, butchers, greengrocers, and bakers, together with pubs, cafes and restaurants, offers a wide range of catering for all tastes. The area has several excellent primary and secondary schools, good bus services to the Town Centre and plenty of attractive parks and playing fields. There is also a quick and easy access to the M5 and the A417 to Swindon via the nearby Brockworth bypass.

## Additional Information

Additional information that may affect your decision to purchase this property is on our website under the property listing or on request from the office.

This includes: Broadband speed and mobile phone signal, flood risk, and area information.

We also ask our clients about known legal aspects such as rights of way, restrictions, and accessibility information.

## Directions

From Cheltenham town centre proceed along Bath Road passing our offices. Continue over the island onto Leckhampton Road until you reach the two mini roundabouts, go straight on at both continuing on Leckhampton Road and take the first Left onto Pilley Lane. Take the First Left into Hillands Drive and the property will be found towards the end of the cul de sac on the left hand side.

What 3 Words [///scarf.float.shock](#)

## Services & Tenure

Tenure - Freehold

Electricity - Mains Supply

Water – Mains Supply

Sewerage - Mains Supply

Heating - Gas

## Local Authority

Cheltenham Borough Council

Council Tax Band - D

## Our reference

CHE160135

11th June 2026

## We'd love to hear from you

140 Bath Road, Leckhampton, Cheltenham, Gloucestershire, GL53 7NG

T: 01242 246982

E: [leckhampton@perrybishop.co.uk](mailto:leckhampton@perrybishop.co.uk)







# Leckhampton, Cheltenham, GL5

APPROX. GROSS INTERNAL FLOOR AREA 1828 SQ FT 169.8 SQ METRES

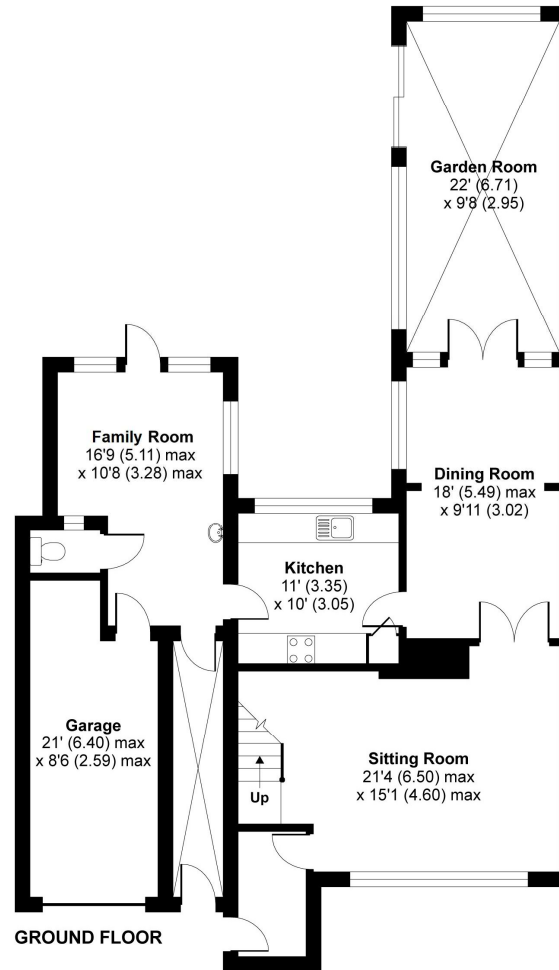

Whilst every attempt has been made to ensure the accuracy of the floor plan contained here, measurements of doors, windows and rooms are approximate and no responsibility is taken for any error, omission or misstatement. These plans are for representation purposes only as defined by RICS Code of Measuring Practice and should be used as such by any prospective purchaser. Specifically no guarantee is given on the total square footage of the property if quoted on this plan. Any figure given is for initial guidance only and should not be relied on as a basis of valuation.

Copyright nichecom.co.uk 2016 Produced for Perry Bishop & Chambers REF : 121770

[perrybishop.co.uk](http://perrybishop.co.uk)

**ID Checks:** Please advise that we charge an admin fee of £25.00 for each individual and £40.00 for a joint purchase when purchasing from us which is payable on a non-refundable basis at the start of the transaction. **Disclaimer:** These particulars should not be relied upon as statement or representation of fact and do not constitute part of an offer or contract. The seller does not make or give, nor do we or our employees have the authority to make or give any representation or warranty in relation to this property. We would strongly recommend that all the information we provide about the property is verified by yourself on inspection. We have not carried out a survey nor have we tested any appliances, services or specific fittings at the property. We work with a number of partner companies that pay an average referral fee of £100.00. For specific information please contact your local branch.

