

PerryBishop

PROPERTY MADE PERSONAL

Union Street, Cheltenham, Gloucestershire, GL52 2JW



Extended period terraced house • Two double bedrooms • Sitting room with feature fireplace • Kitchen/breakfast room • Garden • Convenient location • Permit parking • EPC D



Union Street,

Cheltenham, Gloucestershire, GL52 2JW

Key Features



2
Bedrooms



1
Bathroom



1
Reception

About the property

A deceptively spacious and well presented period terrace house located in the popular area of Fairview, within a short walking distance of the bars, restaurants and amenities to the High Street, including John Lewis and Cheltenham town centre. The property has been modernised, yet retains many character features.

On the ground floor, the hallway leads to a good sized sitting room with feature fireplace, a semi-open plan dining room, also with feature fireplace, and leading to the kitchen/breakfast room which in turn gives access to the courtyard garden. There is also a fully fitted bathroom on the ground floor. On the first floor, there are two good sized double bedrooms.

Amenities

Cheltenham is often known as the gateway to the Cotswolds and famed for its extensive range of festivals, including

National Hunt, literature, music, drama, science, food and drink and jazz.

There are extensive modern shopping facilities within the town and a range of recreational and cultural amenities, including golf courses, racecourse, theatre and cinema.

There are additional excellent communications to the other nearby centres via the M5 giving easy access to Bristol and Birmingham and there is a mainline railway station with services to London.

Additional Information

Additional information that may affect your decision to purchase this property is on our website under the property listing or on request from the office.

This includes: Broadband speed and mobile phone signal, flood risk, and area information.

We also ask our clients about known legal aspects such as rights of way, restrictions, and accessibility information.

Directions

The property can be found via Fairview Road and turning off alongside Bence Builders or via Hewlett Road, taking second left at island in the shopping area. Both approaches lead to Fairview Street alongside the Victorian school. Then almost immediate left takes you into Union Street, where the property can be found at the far end on the left hand side.

What 3 Words: ///tricky.scout.save





Services & Tenure

The tenure is Freehold.

Local Authority

Cheltenham District Council

Council Tax Band: B

Our reference

CHE/NB/RN/04032025

We'd love to hear from you

140 Bath Road, Cheltenham, Gloucestershire, GL53 7NG

T: 01242 246980

E: cheltenham@perrybishop.co.uk



Approximate Gross Internal Area 864 sq ft - 81 sq m

Ground Floor Area 556 sq ft – 52 sq m

First Floor Area 308 sq ft – 29 sq m

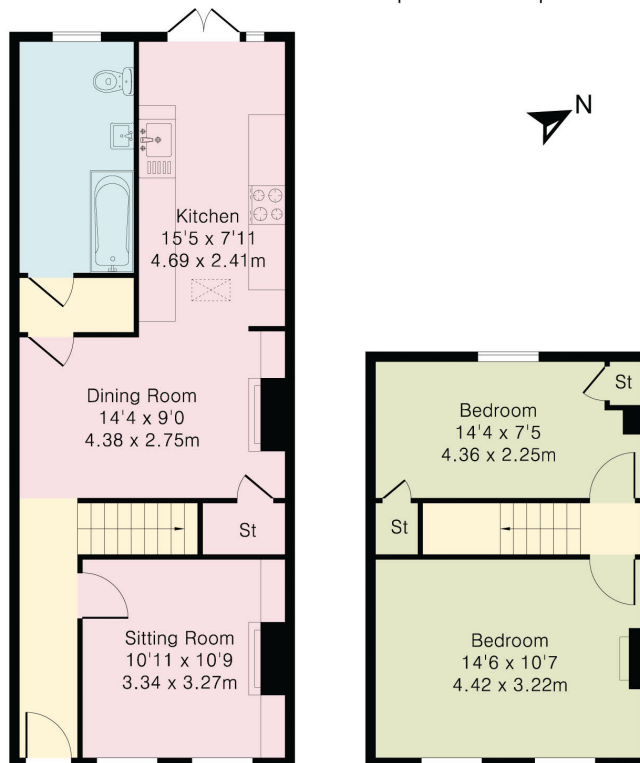

Ground Floor

First Floor

PerryBishop
PROPERTY MADE PERSONAL

140 Bath Road, Cheltenham, Gloucestershire, GL53 7NG

T: 01242 246980

E: cheltenham@perrybishop.co.uk

perrybishop.co.uk

ID Checks: Please advise that we charge an admin fee of £25.00 for each individual and £40.00 for a joint purchase when purchasing from us which is payable on a non-refundable basis at the start of the transaction.

Disclaimer: These particulars should not be relied upon as statement or representation of fact and do not constitute part of an offer or contract. The seller does not make or give, nor do we or our employees have the authority to make or give any representation or warranty in relation to this property. We would strongly recommend that all the information we provide about the property is verified by yourself on inspection. We have not carried out a survey nor have we tested any appliances, services or specific fittings at the property. We work with a number of partner companies that pay an average referral fee of £100.00. For specific information please contact your local branch.

Gloucestershire • Oxfordshire • Wiltshire

