

St. Peters Road, Cirencester, Gloucestershire, GL7 1RG



Victorian semi-detached family home • Five bedrooms • Two reception rooms • Sizeable private rear garden • In need of updating with potential to extend and reconfigure STPP • Central Cirencester location • No onward chain • EPC TBC

St. Peters Road,

Cirencester, Gloucestershire, GL7 1RG

Key Features



5
Bedrooms



2
Bathrooms



2
Receptions

About the property

Offered for sale with no onward chain and situated in one of Cirencester's most sought after residential locations is this five bedroom semi-detached Victorian family home in need of updating as well as offering the potential to extend and reconfigure if required, subject to the necessary permissions and regulations.

The accommodation is arranged over three main floors plus single chamber cellar with the ground floor comprising enclosed entrance porch with access to the cellar, generous hall, sitting room with bay window, separate dining room, kitchen breakfast room, rear lobby, cloakroom and storeroom. The first floor consists of a generous principal bedroom with bay window, two further bedrooms and a wet room, the second floor provides two further double bedrooms and a shower room.

Outside, to the front is a retaining garden. To the rear is an enclosed mature garden with gated side access.

NB - the single chamber is prone to flood.

Amenities

The market town of Cirencester dates back to Roman times and is often referred to as the 'Capital of the Cotswolds'. It is ideally located with the M4, M5 and M40/A40, the mainline train station at Kemble and excellent bus and coach links all within easy reach.

Cirencester benefits from high street stores, independent specialist retailers, a weekly market and there are a number of delightful bistros, cafes, wine bars and public houses to suit all tastes.

There are excellent primary and secondary state schools and a sixth form college campus. There are also good independent schools in the surrounding areas.

Cirencester also boasts a cottage hospital, a leisure centre and a lovely outdoor swimming pool, open from May to September. Other sports are fully catered for including golf, tennis, riding, football, rugby and cricket.

Broadband and Mobile Coverage

For an indication of specific broadband and mobile speed and supply or coverage in the area we recommend the Broadband and mobile coverage checker – Ofcom.

Directions

From our office in Cirencester, turn right into Castle Street. Bear left at the end of the road into Sheep Street. Keep left and at the mini roundabout turn left into Ashcroft Road. Turn right into Ashcroft Gardens and then right again in to St. Peters Road where the property can be found at the end of the road, on the right hand side.

What 3 Words: ///firework.spray.butchers

Services & Tenure

The tenure is Freehold.

Local Authority

Cotswold District Council

Council Tax Band: E

Our reference

CIR/SW/RN/07102024

We'd love to hear from you

2 Silver Street, Cirencester, Gloucestershire, GL7 2BL

T: 01285 655355

E: cirencester@perrybishop.co.uk







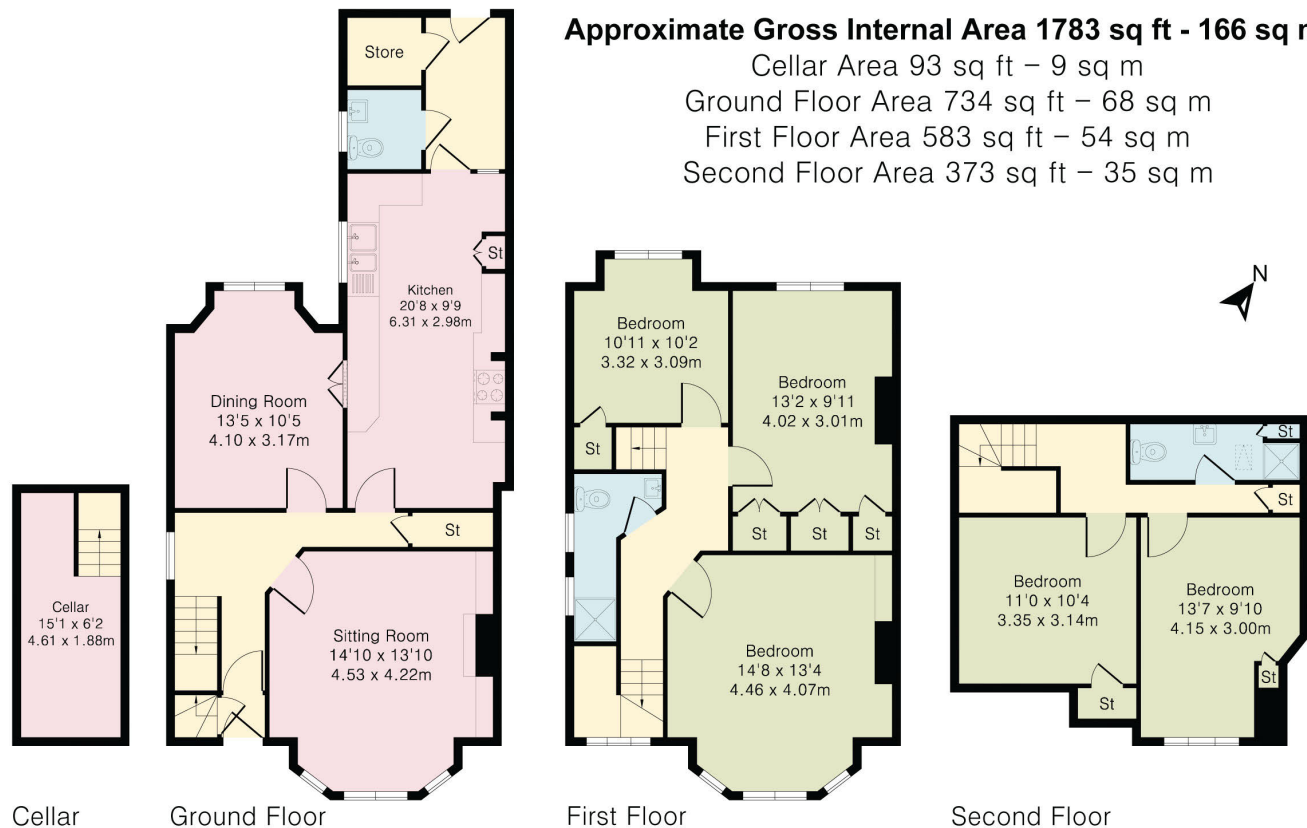

PerryBishop
 PROPERTY MADE PERSONAL

2 Silver Street, Cirencester, Gloucestershire, GL7 2BL

T: 01285 655355

E: cirencester@perrybishop.co.uk

perrybishop.co.uk

ID Checks: Please advise that we charge an admin fee of £25.00 for each individual and £40.00 for a joint purchase when purchasing from us which is payable on a non-refundable basis at the start of the transaction.

Disclaimer: These particulars should not be relied upon as statement or representation of fact and do not constitute part of an offer or contract. The seller does not make or give, nor do we or our employees have the authority to make or give any representation or warranty in relation to this property. We would strongly recommend that all the information we provide about the property is verified by yourself on inspection. We have not carried out a survey nor have we tested any appliances, services or specific fittings at the property. We work with a number of partner companies that pay an average referral fee of £100.00. For specific information please contact your local branch.

Gloucestershire • Oxfordshire • Wiltshire

