

Made For Ever Methodist Church Anchor Road, Kingswood, Bristol, BS15 4RG



Detached chapel dating from 1896 with later single storey extension and nearby detached school room/hall • Residential location • Open viewings on Tues 4th June 2024 from 10:30 am to 11:30 am and Thursday 27th June 2024 from 2:00 pm to 3:30 pm • For sale by informal tender offers due by 12 noon on Wednesday 10th July 2024

Guide Price
£250,000

Made For Ever Methodist Church

Anchor Road, Kingswood, Bristol, BS15 4RG

We are delighted to once again be working with the Bristol & South Gloucestershire Methodist Circuit in marketing this property.

The premises comprise of a detached chapel dating from 1896 with a later single storey extension and nearby detached school room/hall this part dating back to the 1930's.

Standing in a roughly rectangular site with frontage to Anchor Road of 15 metres and return frontage to an unmade lane of 35 metres.

The site has an approximate area of 518m² (0.145 acres) and is situated amongst mature housing.

Location

Kingswood borders both Bristol and South Gloucestershire.

With fast links to Bristol City Centre, you will find here retail shops, pubs, restaurants, theatres, cinemas, museums, art galleries together with historic landmarks from Brunel to Banksy and by complete contrast South Gloucestershire gives you easy access to the Cotswolds and Bath. The Cotswolds is famed for its typical English landscape of lovely green rolling hills and charming little towns and villages. Here you will be enchanted by castles and historic houses with endless parkland and woodland walks. Again a wide range of retail, recreational facilities pubs and restaurants will also be found here.

Directions

From the M4, take the A46 then turn right on to Cotswold Way / Feltham Rd. Turn right onto Abson Road and follow road left onto Shortwood Road/B4465. At roundabout take first exit onto the A4174 and take the third exit onto Station Road Link and soon after first exit onto Anchor Road. The church can be found on the left hand side before the next roundabout.

What Three Words: ///risks.noisy.socket

Viewings

Please contact our Land Department on 01285 646770 to book your appointment. (strictly by appointment only)

1. Tuesday 4th June 2024 from 10:30 am to 11:30 am
2. Thursday 27th June 2024 from 2:00 pm to 3:30 pm

Services & Tenure

The property will be sold with freehold title.

The following services are connected to the property: mains water, electricity, gas and drainage. The chapel is heated by a gas fired boiler and radiators whilst the school room/hall is heated by gas convector heaters.

Town & Country Planning

The present use of the Church is within Class F1 - Learning & Non-Residential Institutions. This would permit the following:-

- a) For the provision of education
- b) For the display of artwork (not for sale or hire)
- c) As a museum
- d) As a public library or public reading room
- e) As a public hall or exhibition hall
- f) For, or in connection with public worship or religious instruction
- g) As a law court

These buildings are not listed as being of heritage value nor are they located within a designated Conservation Area.

Local Authority

South Gloucestershire Council
www.southglos.gov.uk
01454 868004

Method of Sale

The property is offered for sale by informal tender, offers must be made in writing no later than 12 noon on Wednesday 10th July 2024.

These should be submitted on the offer form to ensure that all information required is received. Please email your offer to landandnewhomes@perrybishop.co.uk.

It is the bidder's responsibility to ensure that their offer is received by the prescribed deadline, and the vendor is not bound to accept the highest or any offer. A decision will be made asap after the closing date, with all parties that have made an offer being notified accordingly.

Joint Agent with - CHRISTOPHERS



CHARTERED SURVEYORS





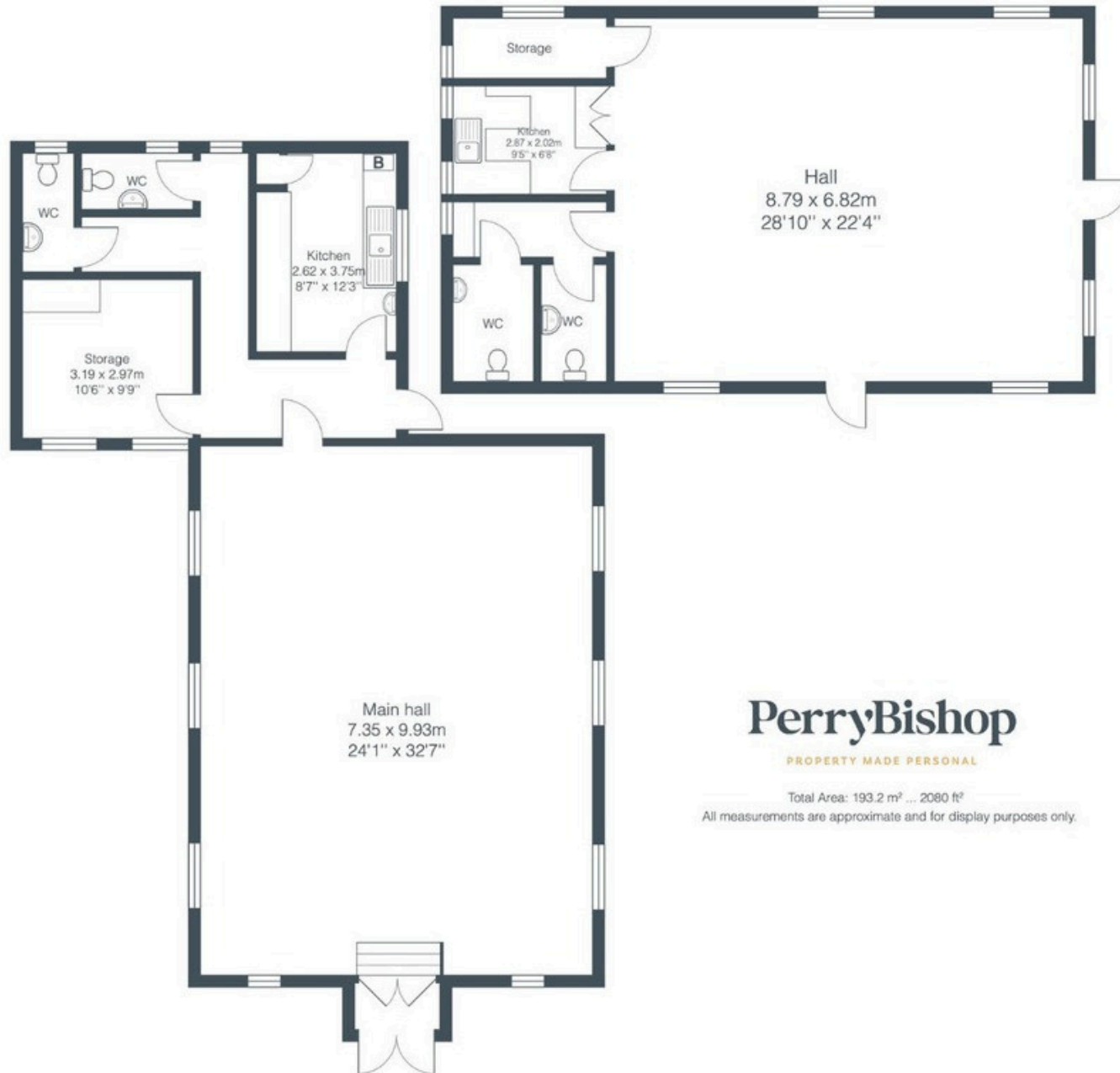

PerryBishop

PROPERTY MADE PERSONAL

Total Area: 193.2 m² ... 2080 ft²

All measurements are approximate and for display purposes only.



2 Silver Street, Cirencester, Gloucestershire, GL7 2BL

T: 01285 646770

E: landandnewhomes@perrybishop.co.uk

perrybishop.co.uk

ID Checks: Please advise that we charge an admin fee of £25.00 for each individual and £40.00 for a joint purchase when purchasing from us which is payable on a non-refundable basis at the start of the transaction.

Disclaimer: These particulars should not be relied upon as statement or representation of fact and do not constitute part of an offer or contract. The seller does not make or give, nor do we or our employees have the authority to make or give any representation or warranty in relation to this property. We would strongly recommend that all the information we provide about the property is verified by yourself on inspection. We have not carried out a survey nor have we tested any appliances, services or specific fittings at the property. We work with a number of partner companies that pay an average referral fee of £100.00. For specific information please contact your local branch.

Gloucestershire • Oxfordshire • Wiltshire

