

Church Hall & Garages, Meadowbank Meadow Road, Cirencester, GL7 1YA



Unique opportunity to acquire a former Spiritualist hall with adjacent garages • Located in the sought-after town of Cirencester • Versatile space including two office areas, main hall and utilities • Lapsed planning • Internal viewings by appointment

Guide Price:
£250,000

Church Hall & Garages, Meadowbank

Meadow Road, Cirencester, GL7 1YA

Perry Bishop is delighted to present to the market this unique opportunity to acquire a former Spiritualist hall with adjacent garages, located in the sought-after town of Cirencester.

Built in the 1980's, the property originally served as a community hall and offers versatile spaces including two office areas, a spacious main hall, a shower room, two WCs, a utility room, and a kitchen. Externally, there is a modest paved amenity area.

The hall previously received planning permission for conversion into a single-story, two-bedroom detached residential property, complete with one off-road parking space. While this planning permission has now lapsed, it presents an exciting opportunity for prospective buyers to reapply or reimagine the potential of this space.

Adjacent to the hall, to its southern side, lies a row of ten single garages which also offer potential for future residential development, subject to obtaining the necessary planning approvals.

The property and garages will be sold with vacant possession, providing a blank canvas for a range of potential uses or developments.

Location

The market town of Cirencester is often referred to as the 'Capital of the Cotswolds'. It is ideally located with the M4, M5 and M40/A40, the mainline train station is at Kemble and there are excellent bus and coach links all within easy reach.

Cirencester benefits from high street stores, independent specialist retailers, and a weekly market. There are also several delightful bistros, cafes, wine bars and public houses to suit all tastes. Cirencester boasts a community hospital, leisure centre and a lovely outdoor swimming pool. Nearby there is golf, tennis, riding, football, rugby and cricket.

Viewings

Internal viewings of the hall are by appointment only. Please call the team on 01285 646770 to arrange.

The site can be viewed from the roadside.

Directions

What Three Words - [///icebergs.ending.thigh](https://www.what3words.com/icebergs.ending.thigh)

Services & Tenure

All main services are connected.

Town & Country Planning

The present use of the Spiritualist hall is within Class F1 - Learning & Non-Residential Institutions. This would permit the following:-

- a) For the provision of education
- b) For the display of artwork (not for sale or hire)
- c) As a museum
- d) As a public library or public reading room
- e) As a public hall or exhibition hall
- f) For, or in connection with public worship or religious instruction
- g) As a law court

Parties interested in alternative residential or commercial uses should address enquiries to the relevant Planning Authority.

Local Authority

Cotswold District Council

www.cotswold.gov.uk / 01285 623000

Method of Sale

The property and garages are for sale by private treaty with a guide price of £250,000.



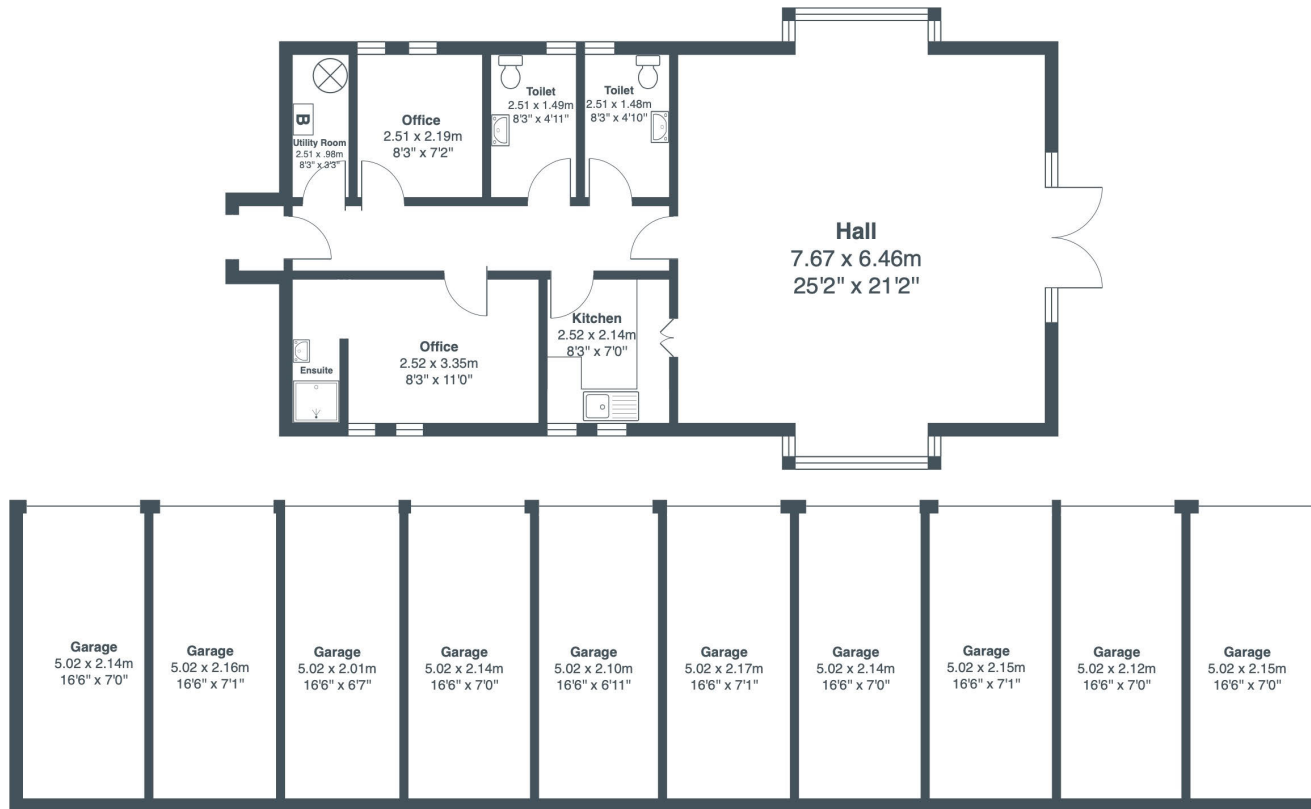

Total Area: 89.7 m² ... 965 ft² (excluding garages)

All measurements are approximate and for display purposes only

PerryBishop

PROPERTY MADE PERSONAL

2 Silver Street, Cirencester, Gloucestershire, GL7 2BL

T: 01285 646770

E: landandnewhomes@perrybishop.co.uk

perrybishop.co.uk

ID Checks: Please advise that we charge an admin fee of £25.00 for each individual and £40.00 for a joint purchase when purchasing from us which is payable on a non-refundable basis at the start of the transaction.

Disclaimer: These particulars should not be relied upon as statement of fact and do not constitute part of an offer or contract. The seller does not make or give, nor do we or our employees have the authority to make or give any representation or warranty in relation to this property. We would strongly recommend that all the information we provide about the property is verified by yourself on inspection. We have not carried out a survey nor have we tested any appliances, services or specific fittings at the property. We work with a number of partner companies that pay an average referral fee of £100.00. For specific information please contact your local branch.

Gloucestershire • Oxfordshire • Wiltshire

